

ARTIST IMPRESSION - MITRE STREET VIEW



Bathurst Hospital Redevelopment

Project Timeline

2022

- \$200M funding announcement
- Project initiation

2023

- Clinical Services Plan approval
- Master Planning
- Value Management Study (VMS)
- Functional Design Briefing
- Concept Design



BHS Staff and Stakeholder engagement

- Project User Groups (PUGs)
- Aboriginal Community Groups
- Bathurst Health Advocacy Network
- Bathurst Regional Council, NSW Police, Correctional Services and Justice Health
- Volunteer groups eg Daffodil Cottage, Hospital Auxiliary
- The BHS Redevelopment Project Community Reference Group



BHS Redevelopment Master Plan

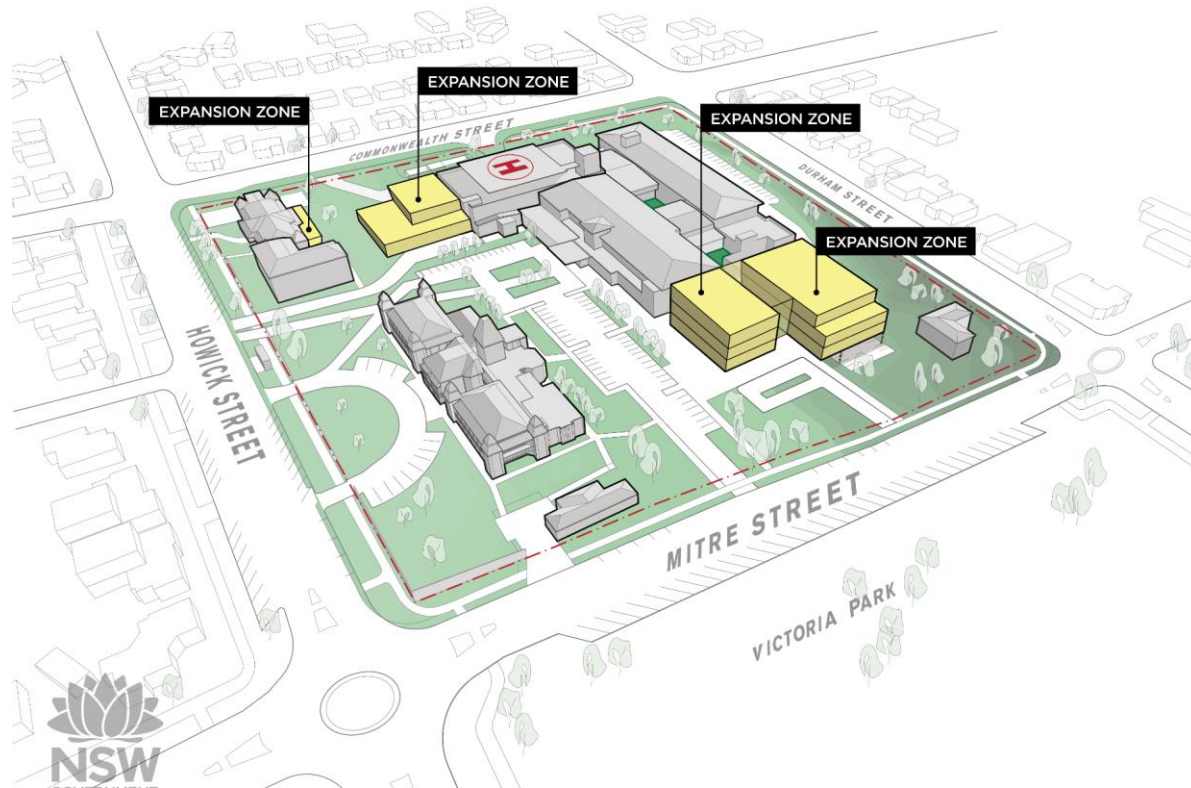

- Expansion zone east towards Mitre Street and Victoria Park – two ‘wings’ including a new front of house and street presence for the hospital
- Expansion zone to the south to increase capacity of ED and operating theatres
- Expansion zone south west corner for Daffodil Cottage

Concept Design - Level 1

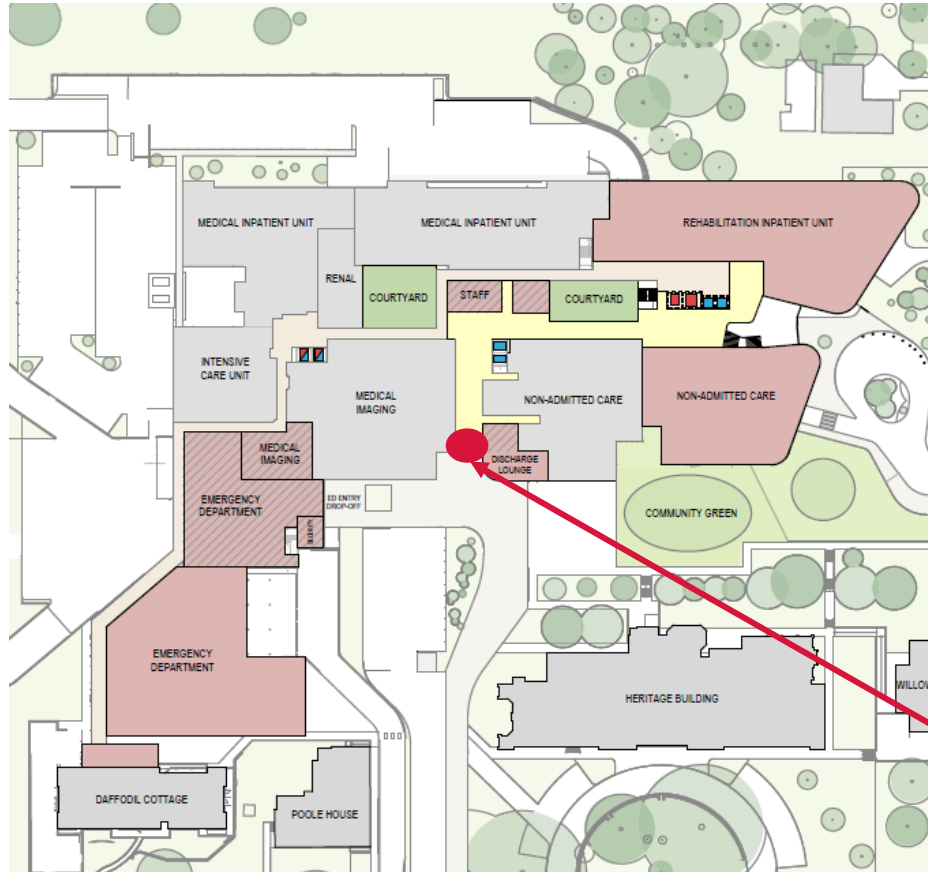

- Daffodil Cottage
- Emergency Department / Medical Imaging
- Medical Inpatient Unit (IPU)
- Rehabilitation IPU
- Outpatients / Ambulatory Care / Specialist Clinics
- Discharge Lounge

Current hospital main entry

Concept Design - Level 2

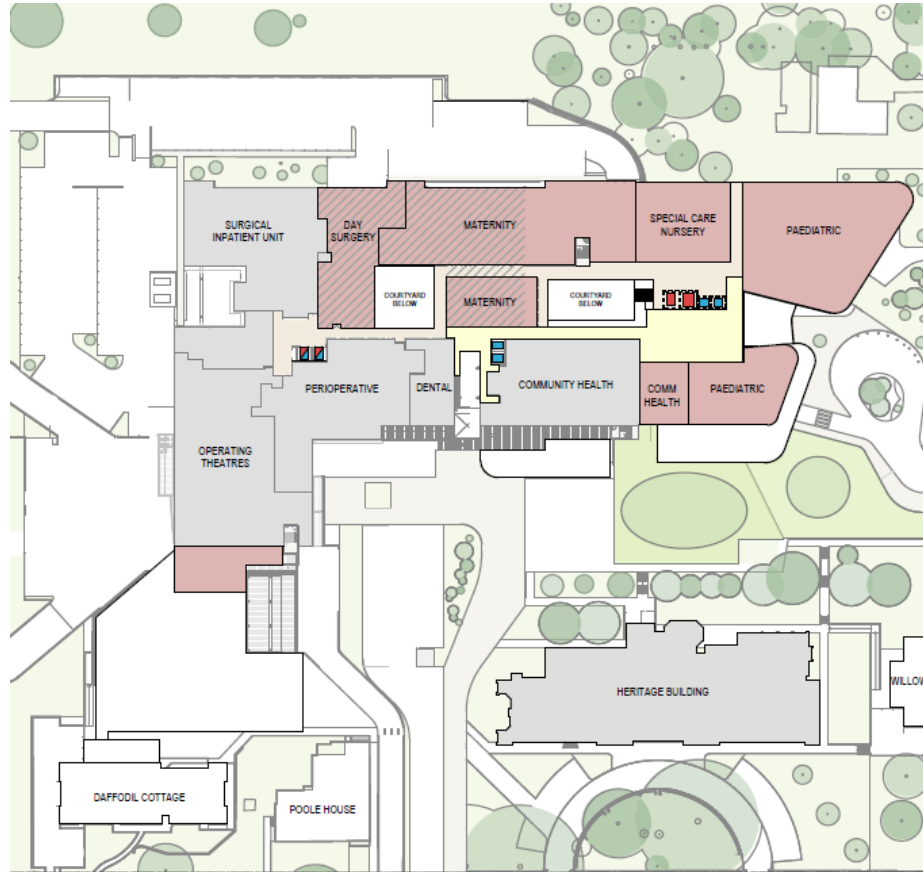

- Operating Theatres
- Surgical Inpatient Unit (23-hour ward)
- Maternity Services
- Special Care Nursery
- Paediatric Inpatient Unit
- Community Health

Concept Design – Ground Floor

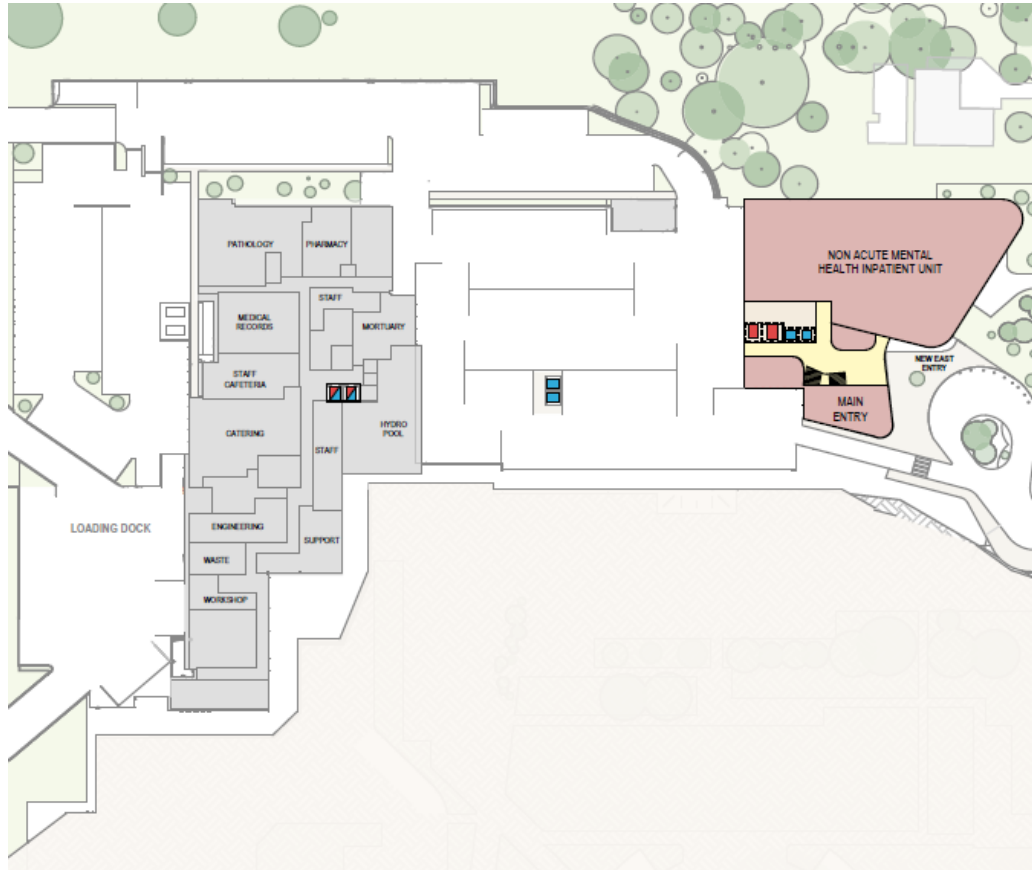

- Voluntary Mental Health recovery unit
- Front of House – café and Aboriginal Cultural Space
- Pathology
- Pharmacy
- Non-clinical support

Concept Design - Lower Ground

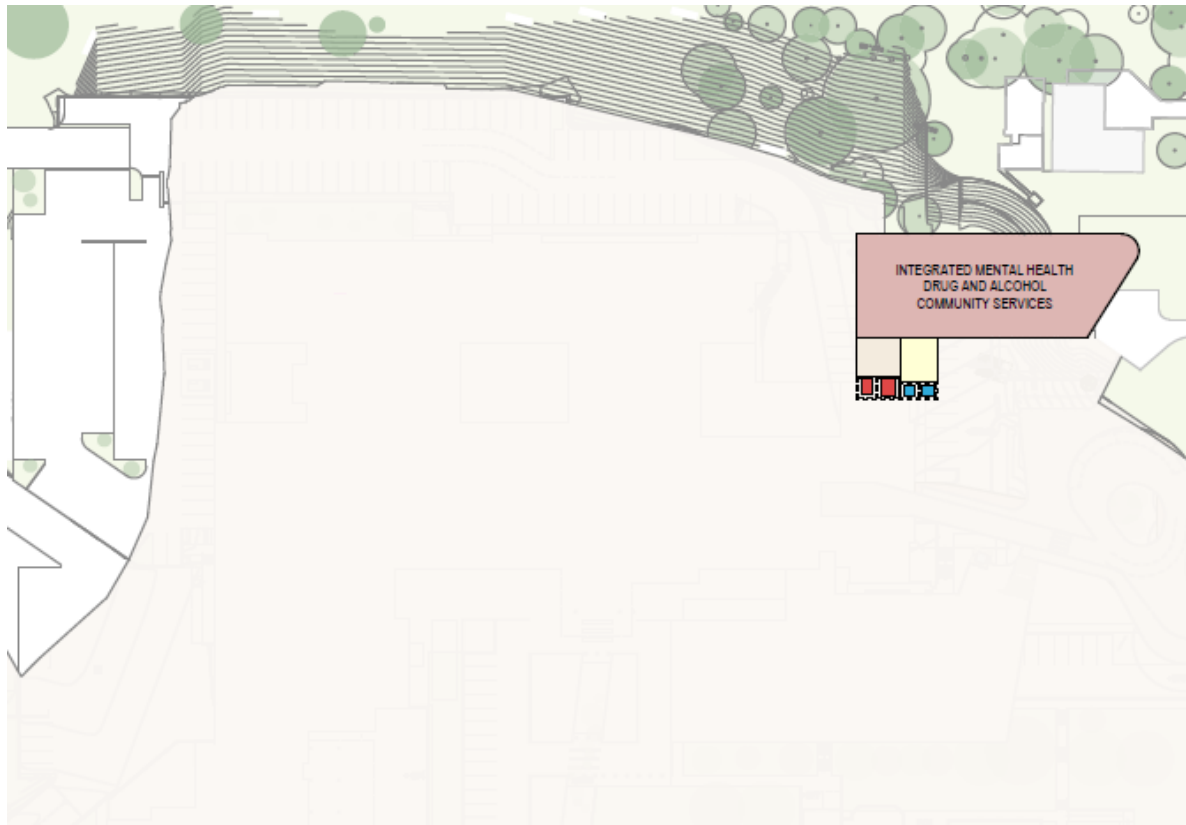

- Integrated Mental Health Drug & Alcohol community Service
- Opioid Treatment Dispensing