

## Justice Health: Freshwater Unit Design, Forensic Hospital

Dear Member,

The HSU has received details of the design and floor plan for the new Freshwater Unit in the Forensic Hospital. Please see attachments.

Members are requested to provide comments or issues by 20 September 2018 to HSU Organiser Denise O'Shaughnessy at [denise.oshaughnessy@hsu.asn.au](mailto:denise.oshaughnessy@hsu.asn.au).

In unity,



Gerard Hayes  
Secretary, HSU NSW/ACT/QLD



HPRM:DG80038/18

Mr Gerard Hayes  
Secretary  
Health Services Union  
Level 2, 109 Pitt Street  
SYDNEY NSW 2000

C/- [denise.oshaughnessy@hsu.asn.au](mailto:denise.oshaughnessy@hsu.asn.au)

Dear Mr Hayes

**Re: Freshwater Unit Design and Development, Forensic Hospital**

As previously advised work has been underway to develop a new Freshwater Unit in the Forensic Hospital.

The project managers and architects have been working with hospital staff to develop the design of the unit based on the Freshwater Unit Statement of Purpose (formerly known as the Model of care).

The staff user group participating in the design of the unit has been comprised of frontline nursing, allied health and medical staff. The staff user group has also included Health Safety Representatives.

I am pleased to be able to provide you a copy of the Freshwater site plan, floor plan, and external design and invite you to review and provide comment on the design by 20 September 2018 via email to [freshwater.development@justicehealth.nsw.gov.au](mailto:freshwater.development@justicehealth.nsw.gov.au).

I note that previously you have requested information on the staff profile and operational policies and procedures. The Network will produce subsequent documents in respect of the staff profile and operational policies and procedures. The Network will continue to consult with you and our staff throughout the development of that additional information.

This is an exciting expansion of the hospital and an important staff and patient safety initiative as we look to meet the developing needs of our patients.

Should you require any further information please contact Damien Eggleton, Co-Director Forensic Mental Health on 9700 3035.

Yours sincerely

Gary Forrest  
**Chief Executive**

// September 2018

LONG BAY CORRECTION COMPLEX

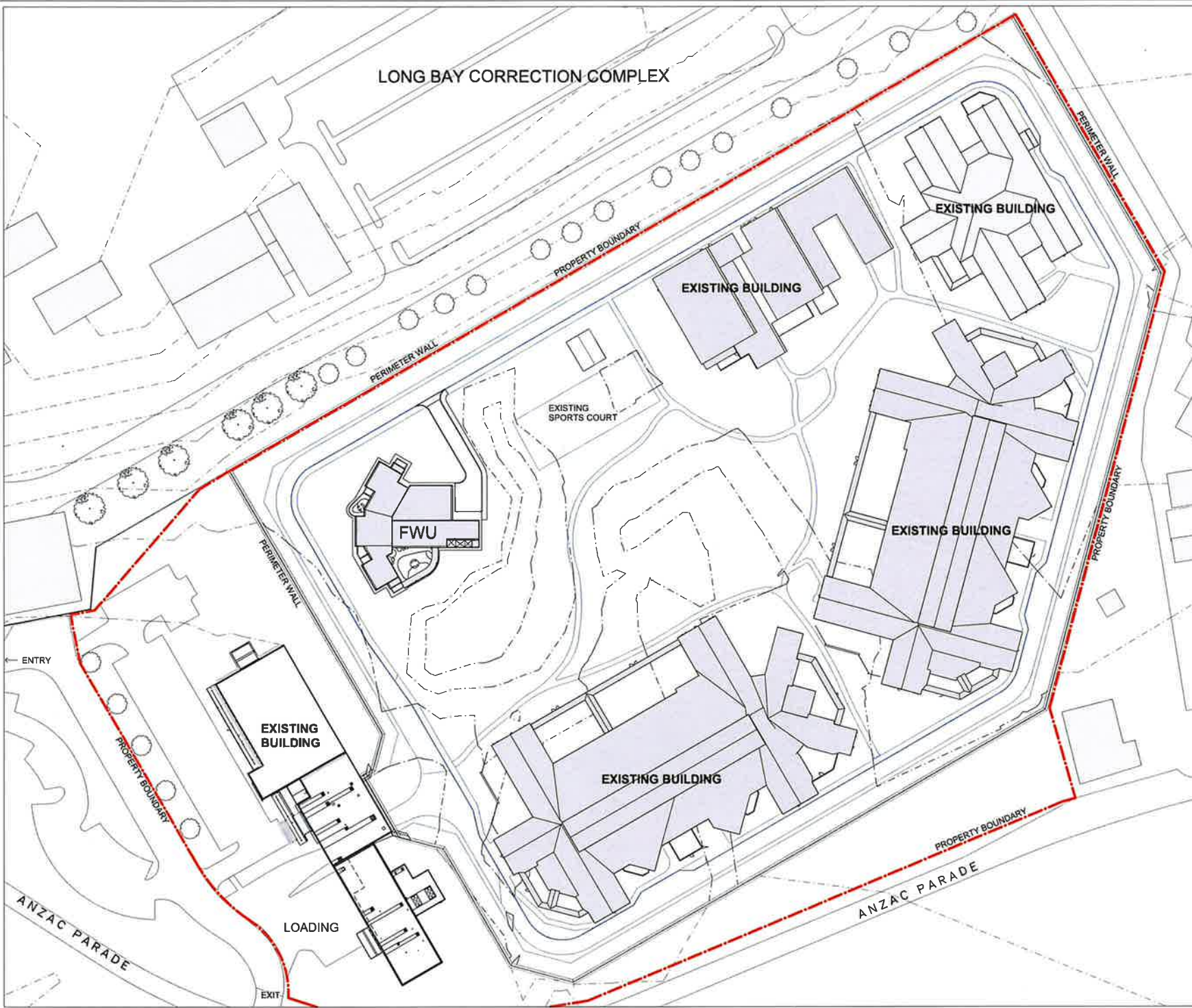

**INFORMATION**

Issue No.	Date	Description	Drawn
1	11/07/18	INFORMATION	LC
2	10/01/18	INFORMATION	LC

**PROJECT MANAGER**  
 JOHN STAFF PROJECTS  
 Level 12, 70 Pitt Street, Sydney NSW 2000,  
 +61 2 8266 0500

**STRUCTURE/CIVIL/MECH/ELECTRICAL ENGINEERING**  
 WGE  
 Level 6/207 Pacific Hwy, St Leonards NSW 2055  
 +61 2 8484 7000

**SECURITY / COMMUNICATIONS**  
 WGE  
 Level 6/207 Pacific Hwy, St Leonards NSW 2055  
 +61 2 8484 7000

**FIRE ENGINEERING**  
 WGE  
 Level 6/207 Pacific Hwy, St Leonards NSW 2055  
 +61 2 8484 7000

**ACOUSTIC**  
 TBC  
 Level 6/207 Pacific Hwy, St Leonards NSW 2055  
 +61 2 8484 7000

Architect  
**NBRARCHITECTURE.**  
 Sydney  
 61 2 8822 2344  
 nbrarchitecture.com  
 Any use or publication of the drawing in all or part without the written permission of NBR ARCHITECTURE is strictly prohibited. No copyright is claimed for the drawing.  
 Approved for public use: Guy Harvey Design Studio, Andrew Quinn SAU, Gerry Reynolds ECU  
 JOHN 10 882 247 885 © 2017

Project  
**FRESHWATER UNIT**  
 at  
 1300 Anzac Parade, Maitland NSW 2030

for  
 JHAFMHN

Drawing Title  
**SITE PLAN - PROPOSED**

Date 28/09/2018 11:18:03 AM  
 Scale 500@A1 or 1000@A3  
 Drawing Reference 17627-A-DD-006  
 Revision 2



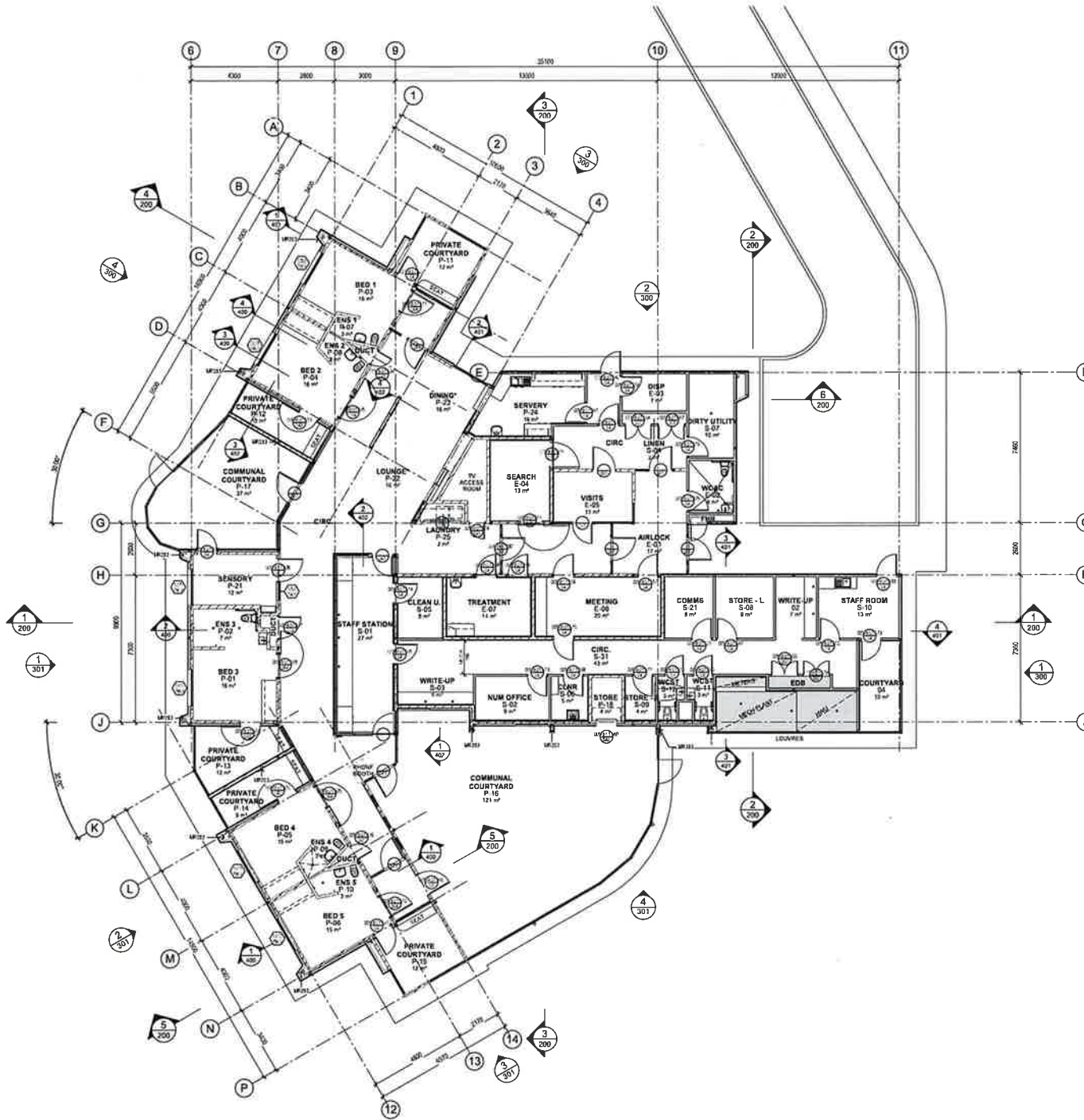

# COORDINATION

Issue No.	Date	Description	Chgd
1	28/08/18	INFORMATION	BS
2	29/08/18	INFORMATION	AH
3	12/07/18	INFORMATION	LC
4	19/07/18	INFORMATION	LC
5	18/07/18	COORDINATION	LC
6	25/07/18	COORDINATION	AH
7	29/08/18	PDC REVIEW	LC
8	21/08/18	COORDINATION	LC

**PROJECT MANAGER**  
 JOHN STAFF PROJECTS  
 Level 12, 70 Pitt Street, Sydney NSW 2000,  
 +61 2 8256 0500

**STRUCTURAL/MECHANICAL/ELECTRICAL ENGINEERING**  
 WGE  
 Level 6/267 Pacific Hwy, St Leonards NSW 2055  
 +61 2 8484 7000

**SECURITY / COMMUNICATIONS**  
 WGE  
 Level 6/267 Pacific Hwy, St Leonards NSW 2055  
 +61 2 8484 7000

**FIRE ENGINEERING**  
 WGE  
 Level 6/267 Pacific Hwy, St Leonards NSW 2055  
 +61 2 8484 7000

**ACOUSTIC**  
 TBC  
 Level 6/267 Pacific Hwy, St Leonards NSW 2055  
 +61 2 8484 7000

Architect  
**NBRSEARCHITECTURE.**

Sydney  
 61 2 8822 2344 nbsarchitecture.com  
 Any form of reproduction of this document, in part or in full, without the written permission of NBRSEARCHITECTURE, is prohibited. All rights reserved. All other trademarks and registered trade names are the property of their respective owners.

Project  
**FRESHWATER UNIT**

at  
 1300 Anzac Parade, Maitland NSW 2036  
 for  
 JH&FMHN

Drawing Title  
**GROUND FLOOR PLAN**

Date: 28/08/2018 9:52:44 AM  
 Scale: 100@A1 or 200@A3  
 Drawing Reference: 17627-A-DD-102  
 Revision: 9





